

G60-ZMA3 Mains Adapter

OPERATING INSTRUCTIONS

FOR OEM USE ONLY

⚠ WARNING

Read these instructions carefully and completely before installing or operating.

Do NOT use a product if you suspect it has been subjected to high temperatures, damaged, tampered with, or taken apart.



Figure 1: G60-ZMA3 contents

TECHNICAL DATA

Approval: DIN EN60335-1
 Input: 100-240 V; 50/60 Hz; 0.2A
 Output: 6.0 V; 1000 mA
 Cable Length: 3 m

INSTRUCTIONS

1. Choose the appropriate outlet plug (see figure 2). Australian outlet plug available upon request.

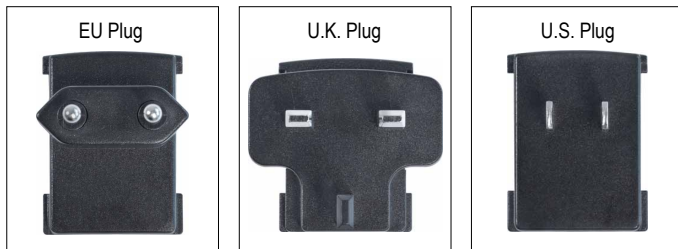

Figure 2

2. Place the longer tabs on the plug end into the corresponding tab cutouts of the adapter (see figure 3).

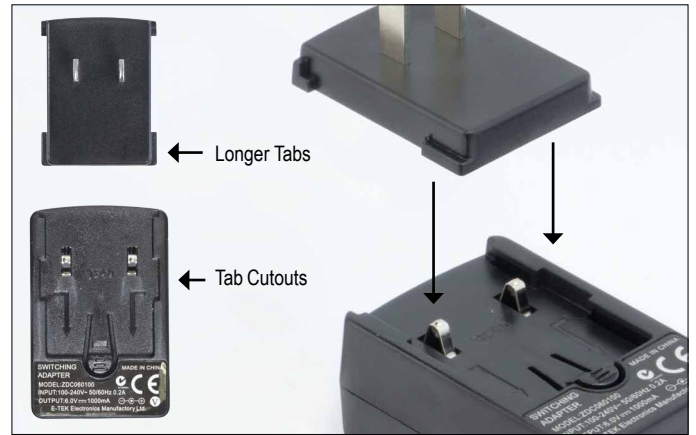

Figure 3

3. Push down and then slide forward until the plug snaps into place (see figure 4).



Figure 4

4. To remove the plug, press down on the release button while sliding out the plug (see figure 5). Lift the plug out at the tab cutouts.



Figure 5